

**DC OUTPUT :**                      **0 -2000 Amps ( 25kW )**                      **0-600 Volts**



**Dimensions :**  
**L:483mm x H:400mm x P:620mm**

**U**   **I**   **P**   **OVP**   **OT**   **USB**   **RS232**   **LAN**   **IEEE**   **CAN**   **Profibus**

## Presentation :

- Presentation : 19 inch rack or cabinet, Height 7U
- Minimum volume and weight for maximum capacity
- Switched mode technology
- Voltage and current controlled by PWM (Pulse width modulation)
- On request : Programmable voltage / current : 0-10V or 4-20mA, isolated to 1500 Vrms
- Over-voltage protection (OVP) / Over-temperature protection (OTP)

## MICROLAB DC MX

Power	MXP 25kW
<b>Weight</b>	80kg
<b>Volts</b>	<b>Amps</b>
0 - 10	0 - 2000
0 - 20	0 - 1250
0 - 30	0 - 750
0 - 40	0 - 600
0 - 60	0 - 400
0 - 80	0 - 300
0 - 120	0 - 200
0 - 150	0 - 160
0 - 200	0 - 120
0 - 300	0 - 80
0 - 600	0 - 40

Voltage superior to 600 Vdc : on request.

#### Descriptions :

- . Polycarbonate front panel
- . Two-colour On/Off LED : Off = red / On = green
- . Voltage and current adjustable using two 10-turn potentiometers (U-adj and I-adj)
- . Two modes of operation : constant current (CC) and constant voltage (CV) indicated by two LEDs
- . 2000-point digital displays (VOLTAGE / CURRENT)
- . Power output activated by pressing « OUT »
- . Manual Voltage / Current preset (U/I set push butto) shown on displays
- . Power input by standardised pluggable connector
- . Power outputs on insulated or screw terminal block

**Power : MXP 25 KW**  
**Weight : 80 Kg**

#### AC Input

Voltage	400 Vac TRI +/- 10% without neutral + PE
Frequency	47 / 63 Hz
Power factor	> 0,95

#### DC Output

Power	25 KW
Voltage	0 to 600V
Current	0 to 2000A
Mode of operation	CV-CC
Residual ripple	< 0,5% of the normal gauge
Accuracy (Voltage and current	< 0,2% of the normal gauge
Stability	< 0,2% of the normal gauge
Linearity	< 0,2% of the normal gauge
Distorsion	< 0,5%

Temperature	0 à +40°C ( 55°C derating )
Relative Humidity	85% without condensation
Cooling	Controlled air cooling
Dielectric Rigidity	1500 Vrms

#### Customisation :

##### Digital control :

- 2-wire RS 485/ Ethernet / Wifi
- Profibus DP
- Standard : Schneider/ Siemens/Wago/Phoenix...

##### Analog control :

- U and I Inputs / Outputs
- 0-10V or 4-20mA isolated 1500 Vrms

15-pin D-Sub connector for remote programming

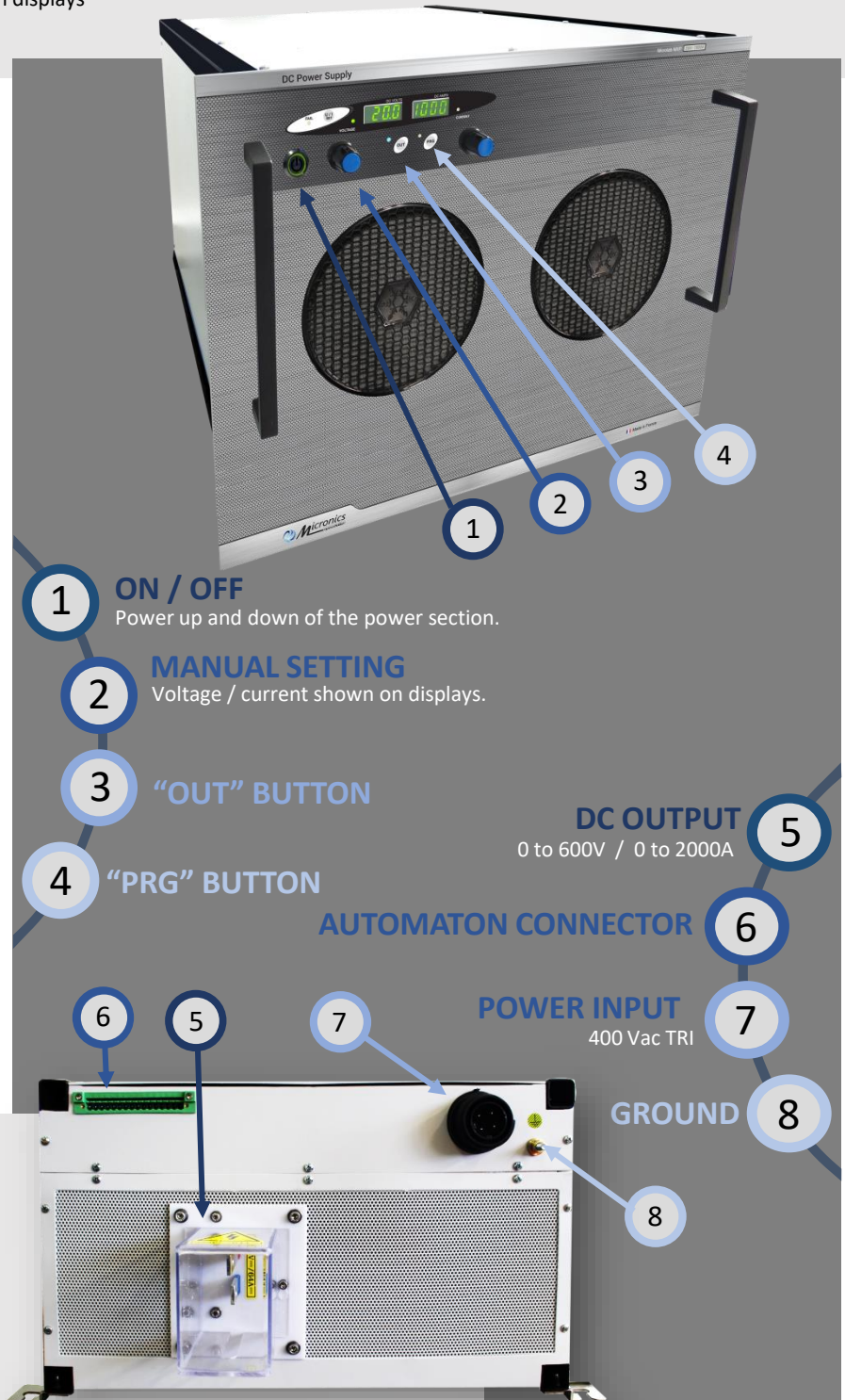

Non-biding document, may be amended  
without notice,  
Réf: 27218 / MXP 25 KW